

e-STUDIO306LP
e-STUDIORD30



World's first MFP with erasable toner
Save up to 80% paper usage
Unique technology
Reduce carbon emissions



Ecology - Efficiency - Economy

5x1=1
THE ECO-MFP FORMULA

TOSHIBA
beyondworkflow

Changing the way you print

Introducing the new Toshiba e-STUDIO306LP, a revolutionary design in our award winning MFP line-up. It is the first MFP to incorporate a unique erasable toner enabling the output to be erased and re-used multiple times.

Instead of discarding prints which are no longer required, now you can erase and re-use each sheet of paper up to five times.

That's good for you and the environment!



Print

Print and copy with erasable toner

Print Scan Copy Fax



Scan

Digitise documents for electronic archiving



Erase

Erase the print to allow re-use of paper

Scan Erase Sort

Sort

Sort paper into reusable and non-reusable

Re-use

The office revolution

Toshiba now allows you to re-use your paper, delivering a far better value for money ratio.

Optimising the use of your resources is an effective way to increase profitability. For example, by using the same sheet of paper five times with the e-STUDIO306lp/rd30, you reduce your paper consumption by 80% without reducing your overall print quantity.

Lets break that down, assuming you print 4,000 pages per month, this means that after five years you will have saved 192,000 sheets of paper. In other words: the same amount of paper which you would usually use in one year, could now last five years!



The Toshiba Paper Reusing Device e-STUDIOrd30 is capable of de-colourising the text and images printed on documents with the e-STUDIO306lp thus allowing you to use the paper again.¹⁾ This can significantly reduce your paper consumption. As a result, you'll be saving valuable resources whilst contributing to a greener tomorrow.

¹⁾ As latent toner remains on the paper after erasing, it is not recommended to print confidential documents on this system.



Paperless vs less paper

The notion of a paperless office was first discussed over 30 years ago, yet today we still print billions of pages each year. According to an IDC study¹⁾ two million A4 pages are printed every minute in the EMEA region (Europe, Middle East and Africa) alone. That amounts to almost three billion pages per day!

Without needing to be filed, many pages are simply thrown away. With the e-STUDIO306LP/RD30 Toshiba now allows you to reuse your paper, so on average each sheet can be used up to five times. This could significantly change the impact your office has on the environment.

So even if the time for paperless offices isn't quite here, you can now reduce your paper usage without having to print less.

¹⁾ IDC. Worldwide Page Volume and Vendor Share Program, October 2012.



TOSHIBA
beyond workflow

Reuse before recycling

Reduce - Reuse - Recycle. These 3Rs form the basis of environmental awareness. The e-STUDIO306LP/RD30 now fills the gap by making the re-use of paper possible.

Most of our natural resources are limited so it makes sense to use them as efficiently as possible.

Trees are a renewable resource, but it takes many to make paper. The paper production process also involves the use of water, a natural resource vital for all life on the planet but increasingly becoming a scarce commodity in certain parts of the world.

Over the past few years the process of making paper has improved and become more environmentally friendly.

Decades of innovations have resulted in resources being used to their fullest extent. Additionally, recycling paper has helped save resources. Toshiba now adds a new level to the environmentally conscious use of paper: the ability to re-use before recycling.

By using paper five times over before recycling, it is possible to save 80% of natural resources otherwise needed to print the same volume.



THE **ECO-MFP** FORMULA

Toshiba's unique eco-MFP cannot only print, copy, scan and fax but it also erases each page up to five times.

Reduce your paper consumption by up to 80% with regular office paper.



e-STUDIO306LP

e-STUDIO RD30

Integrated into your fleet

The e-STUDIO306LP is more than just a green MFP. Its advanced technology is based on Toshiba's e-BRIDGE controller to ensure flexible connectivity with diverse applications and workflows.

Functionality

The e-STUDIO306LP offers you full functionality. Monochrome printing and copying with special blue toner as well as a colour scan function come standard. And if desired, you can extend the systems functionality by adding a fax option.

Productivity

With a paper capacity of 2,300 sheets, the e-STUDIO306lp is ready to handle large print jobs. This means you can make full use of the 30 pages per minute print speed without refilling the paper supply.

The system can also scan in colour with a resolution of up to 600 x 600 dpi at a scan speed of up to 57 images per minute.

Usability

Ease of use is vital if you want to be effective. That's why all Toshiba products are designed with the customer's needs in mind. Ensuring smooth workflow is just a few clicks away, the intuitive 9" (22.8 cm) LCD touch panel gives access to all functions on the e-STUDIO306LP.

Connectivity

Thanks to Toshiba's e-BRIDGE controller, the e-STUDIO306LP can easily form part of your modern workflow.

A large choice of optional plug-ins, connectors and a fleet management tool allow you to easily customise the system according to your needs and existing workflows.

e-BRIDGE Technology

Toshiba's e-BRIDGE technology lies at the high-tech core of almost all e-STUDIO systems. It is the functional foundation for fast document processing and can combine with highly productive applications.

This technology enables you to take advantage of Toshiba's Universal Printer Driver and enjoy the intuitive interface used on all e-BRIDGE-based devices. It also allows simple yet effective administration and service of your entire Toshiba fleet.



TOSHIBA
beyond workflow

Save and erase

The e-STUDIORD30 fully integrates into your digital workflow. It is capable of electronically archiving the content of your documents before erasing it.

The e-STUDIORD30 can do more than just de-colourise paper. It is capable of converting your documents into electronic files and saving them for you.

Equipped with a single pass duplex scanner the system ensures fast conversion into JPG, TIFF or PDF format. These files are then stored on your server and become part of your digital archive, giving you access to the content at any time.

Once the document has been digitised, the content of the sheet is erased. To achieve this, the special toner on the paper is de-colourised by applying heat.

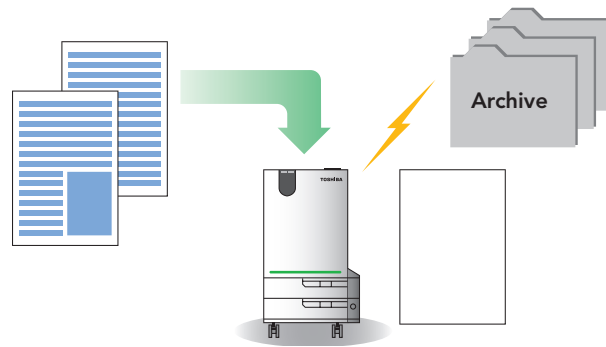

As a consequence, the toner turns from blue to transparent, thus virtually erasing everything that was printed.

Automatically, the erased sheet is scanned yet again and sorted into reusable and non-reusable paper, then placed into the respective output cassette for collection.

This entire process - archiving, erasing and sorting - is completed within just a few seconds. So with the new e-STUDIO306LP/RD30 in your fleet, being environmentally conscious will not reduce your productivity.

Permanent and non-permanent documents

Some documents just have to be filed and kept, like when there are legal obligations compelling you to do so. These are permanent documents, printed with the intention to be kept long-term.

But very often, we print documents even though we know we won't need them for long. Eventually, as can be expected, we throw them away. Sometimes we even print documents knowing very well we will throw them away within a few minutes or hours. Just think of all the documents you print just as a reminder to do something or those you print to proof-read before sending. For these non-permanent documents, the e-STUDIO306LP/RD30 is the perfect solution. Simply re-use the the same sheet of paper for your next non-permanent print job. Over and over again.



For a greener tomorrow

Efforts to reduce carbon emission are being made on a global level. With the possibility to reuse paper when printing, the e-STUDIO306LP/RD30 helps achieve this goal.

Greenhouse gases have a huge impact on the global climate and efforts to reduce the CO₂e emission are being made all over the world.

Over the entire life cycle of an MFP, it is the paper - not the manufacturing, transport or usage - which accounts for largest part of the CO₂e emission. This is due to the fact that when producing one tonne of paper, approximately one tonne of CO₂e is emitted.¹⁾

As the e-STUDIO306LP/RD30 is capable of erasing text and images from documents printed on the e-STUDIO306LP, it allows you to reuse the paper. If you use the same sheet five times, you reduce your paper consumption by 80%. This of course also significantly reduces the CO₂e emission and helps protect the environment.



Technically Speaking

CO₂ vs. CO₂e

Carbon dioxide (CO₂) is one of the most prevalent greenhouse gasses and has become a proxy when measuring greenhouse gas emissions. However, it is only one of many greenhouse gases. Others include water vapour, methane, nitrous oxide and ozone.

To take into account the emission of these other greenhouse gases, an equivalent measure has been devised by scientists: the CO₂e (carbon dioxide equivalent). It allows other greenhouse gases to be expressed in terms of CO₂.

The calculation is based on the relative global warming potential (GWP) of the different greenhouse gases. With CO₂ having a GWP of 1, methane (CH₄), for example, has a GWP of approximately 25. Therefore, the emission of one tonne of CH₄ is equivalent to emitting 25 tonnes of CO₂.

So by using the CO₂e, a far more accurate greenhouse gas emission can be measured, giving you a more precise picture of the effects of these emissions.

¹⁾ Defra. Guidelines to Defra /DECC's GHG Conversion Factors for Company Reporting. 2011, p. 40.

Specifications

GENERAL

| | |
|-------------------------|--|
| Copying Process/Type | Erasable Dry Process/Laser Technology |
| Original Reading Method | CCD Line Sensor |
| Copy/Print Resolution | 2400 x 600 dpi (with Smoothing) |
| Copy/Print Speed | 30 PPM |
| Scanning | Colour Scanning |
| Warm-Up Time | Approx. 65 Seconds |
| First Copy Time | 4.9 Seconds |
| Multiple Copying | Up to 999 Copies |
| Standard Paper Supply | 2 x 550-Sheet, 100-Sheet Stack Feed Bypass |
| Maximum Paper Supply | Up to 2,300 Sheets |
| Acceptable Paper Size | Cassette: A5-R to A3 (64-80g/m2) Bypass: A5-R to A3 (64-80g/m2) |
| Memory | 1GB RAM, 160 GB Self-Encrypting HDD |
| Reduction/Enlargement | 25% to 200% |
| Control Panel | 9" Wide VGA Colour Touch-Screen |
| Dimensions | Approx. (W x D x H) 575 mm x 586 mm x 756 mm |
| Weight | Approx. 59kg |
| Power Consumption | Max 1.5kW, Less than 1.0W Super Sleep Mode (220 – 240V) |

PRINTING FUNCTIONS

| | |
|--------------------|---|
| PDL Support | PCL5e, PCL6, PostScript3, XPS, PDF |
| Supported OS | Windows XP/Vista/7/8, Windows Server 2003/2008/2012 Mac X OS 10.5.7/10.6.8/10.7/10.8; UNIX (SUN Solaris v2.6.2/7.7.8/8/9/10, HP-UX v10.2/11x, IBM AIX 4.3.3), Linux, SCO, 64bit OS, CUPS |
| Network Protocols | IPX/SPX, TCP/IP (IPv4/IPv6), Ether Talk, NetBIOS over TCP/IP |
| Printing Protocols | Windows Printing (SMB), LPR/LPD, IPP w/Authentication, Network, Apple Talk PAP, Ether Talk, Port 9100 (bi-directional), WS Print, FTP |
| Print Drivers | Universal, Postscript 3, XPS |
| Interface | Standard: Ethernet 10/100/1000BaseT, USB 2.0, Option: IEEE802.11b/g (Wireless LAN module) |

SCANNING FUNCTIONS

| | |
|-----------------|---|
| Scan Speed (A4) | 57spm @300dpi (B&W)/43spm @300dpi (Colour) |
| Scan Mode | B&W, Grayscale, Colour/ACS |
| Scan Resolution | 100 dpi, 150 dpi, 200 dpi, 300 dpi, 400 dpi, 600 dpi |
| File Format | B&W: TIFF, PDF, XPS, Grayscale/Colour: JPEG, TIFF, PDF, Slim PDF, XPS, ACS: TIFF, PDF, XPS, MS Word, MS Excel, Searchable PDF w/Adv. Scanning option |

ELECTRONIC FILING FUNCTIONS

| | |
|----------------------------|---|
| Operation Method | Colour Touch Screen Control Panel or Client PC |
| Number of Boxes | 1 Public Box; 200 Private User Boxes |
| Capacity of Boxes | 100 Folder per Box; 400 Documents per Box/Folder; 200 Pages per Documents |
| Input to Box (Multi agent) | Copy & Box, Print & Box, Received Fax / i-fax to File & Box, Received fax / i-fax to email & Box, Received fax/i-fax to fax/i-fax relay & Box, Fax to mailbox & Box, Scan to File & Box, Scan to email & Box |
| Output from Box | Box to Print, Box to email (destination type: To, CC: BCC:) |
| Box N/W Access | TWAIN Driver, File Downloader |

INTERNET-FAX/NETWORK-FAX FUNCTIONS

| | |
|---------------|--|
| Compatibility | ITU-T.37 (Simple Mode) |
| Drivers | Windows XP/Vista SP2/7/8, Windows Server 2003/2008/2012, Mac OS 10.4 or later |

NETWORK/DEVICE MANAGEMENT UTILITY

•TopAccess •TopAccess DocMon •Address Book Viewer •e-BRIDGE Fleet Management System (Opt.)

OPTIONS

| | |
|--|---|
| Facsimile Unit GD1250 | Super G3, G3 |
| Compatibility | MH / MR / MMR / JBIG |
| Data Compression | Approx. 3 Seconds per Page |
| Transmission Speed | Max. 33.6 Kbps |
| Fax Modem Speed | Transmission and Reception 1GB (HDD); Backup Permanent (HDD) |
| Fax Memory | 100 Jobs, 2,000 Destinations Max; 400 Destinations/Job, Max. 1000 pages/file |
| Memory Transmission | 0.7 Seconds per Page (A4); 50 Scans per Minute |
| Scan Speed | Text, Text/Photo, Photo, B&W only |
| Scanning Mode | 256 levels (error diffusion) |
| Grayscale | |
| RADF (Automatic Document Feeder) MR3026 | |
| Original capacity (80g/m ²) | 100 sheets, 1000 sheets with continue mode (A4, A3) |
| Original setting | Face-up |
| Available original size & weight | A5-R to A3, 35 - 157g/m2 (simplex), 50 - 157g/m2 (duplex) |
| Dimensions (W x D x H) & weight | 575 mm x 528 mm x 135 mm, 12.5kg |
| Paper Feed Pedestal KD1033 | |
| Paper supply (80g/m ²) | Approx. 550 sheets, 1 drawer |
| Paper size & weight | A5-R to A3 (64 - 80g/m2) |
| Dimensions (W x D x H) and weight | 727 mm x 716 mm x 450 mm, 21kg |
| Drawer Module MY1042 | |
| Paper supply (80g/m ²) | Approx. 550 sheets (80g/m2), 1 drawer |
| Paper size & weight | A5-R to A3 (64 - 80g/m2) |
| Dimensions (W x D x H) and weight | 688 mm x 652 mm x 212 mm, 1.5kg |
| Job Separator MJ5009 | |
| Capacity (80g/m ²) | Upper Tray: Approx. 150 sheets, Lower Tray: Approx. 250 sheets |
| Dimensions (W x D x H) & weight | 496 mm x 381 mm x 279 mm, 3.3kg |
| | • Platen Cover KA1640PC • Work Tray KK4550 • 2nd Line FaxGD1260F • IPsec Enabler GP1080 |
| | • Data Overwrite Enabler GP1070 • Wireless LAN Adapter GN1060 • Antenna GN3010 |
| | • Meta Scan Enabler GS1010 • Unicode Font Enabler GS1007 • Advanced Scanning Re-Rite 8 GB1280V8 |
| | • Work Tray KK4550 • Desk MH2050 • Accessible Arm KK2550 • Manual Pocket KK1660 |
| Paper Reusing Device Erasing Unit KH1020 (e-STUDIO RD30) | |
| Erasing Method | Twin Heat Roller Duplex Heating Method |
| Scanning Method | Single-pass Duplexing Automatic Document Feeder |
| Warm-up Time | Approx. 40 seconds (Approx. 12 seconds from Energy Saving Mode) |
| Dimensions (W x D x H) | 470 mm x 470 mm x 825 mm |
| Weight | Approx. 45kg |
| Power Consumption | Max. 1.5 kW, Less than 3W Sleep Mode (220-240V) |
| Operating Environment | Temperature: 10 - 30° C Humidity: 20 - 85 % (No Condensation) |
| Paper Feed Tray | |
| Loading Capacity | Max. Stack Height: 15 mm (Approx. 100 sheets; A4 (80g/m2) |
| Acceptable Paper Size | A4, A5, B5 |
| Acceptable Paper Weight | 64 - 80g/m2 (Plain Paper) |
| Erase (Standard) | |
| Erase Speed (A4) | Erase only: 30 sheets/minute Erase & Sort/Scan: 15 sheets/minute |
| Scan (Standard) | |
| Resolution | 100, 150, 200, 300 dpi |
| Scan/Erasing speed | 15/30 sheets/minute |
| Colour Modes | Full Colour, Grayscale, B&W, Blue Original |
| File Formats | TIFF, PDF, Slim PDF, JPEG |
| Scan Functions | Scan to USB, Scan to Network Shared Folder (SMB, WebDAV), Management Scan |
| Device Management | |
| TopAccess for Remote Administration and Configuration (Incl. Reuse Count Settings) | |

DISTRIBUTED BY

ISO 9001 and ISO 14001 Certifications

These highly acclaimed certifications are recognised worldwide as measures of top quality and environmental management excellence. They are awarded to manufacturers for facilities and practices meeting strict standards set by the Geneva based International Standardization Organisation. To date, four copier sales affiliates and all Toshiba TEC manufacturing facilities where copiers, accessories, supplies and parts are produced have received ISO 9001 certification, while four copier sales affiliate and all Toshiba TEC manufacturing facilities have received ISO 14001 certification — even more reasons to count on Toshiba.

Microsoft and Windows[®] are registered trademarks of Microsoft Corporation in the United States and/or other countries. Adobe[®] PostScript[®] Level 3[™] is a registered trademark of Adobe Systems, Inc. Mac OS[®] is a registered trademark of Apple Inc. All other brand and/or product names are trademarks of their respective owners.

This brochure was compiled based on information that was accurate prior to product launch. Product design and specifications are subject to change without notice. The colour(s) of the actual product may vary from the colour(s) shown in this brochure. No part of this material may be used or reproduced in any manner whatsoever without permission. ¹1GB = 1 billion bytes; the actual formatted capacity is less. Available capacity will also be less if software applications are pre-installed. Days for function availability may differ by region. "e-filing" is an abbreviation of "electronic filing". Warm-up time and print speed may vary depending on the operating environment. ©2013 TOSHIBA TEC CORPORATION All rights reserved.

As an ENERGY STAR Partner TOSHIBA TEC CORPORATION has determined that this multifunctional device model meets the ENERGY STAR guidelines for energy efficiency.



TOSHIBA (AUSTRALIA) PTY LIMITED
 ABN 19 001 320 421
 Building C, 12-24 Talavera Road, North Ryde, NSW 2113
 Tel: (02) 9887-6000 Fax: (02) 9815-6274
New Zealand Office
 58 Lunn Avenue, Mt Wellington, Auckland, NZ
 Tel: (9) 570-8530 Fax: (9) 570-8930
www.eid.toshiba.com.au
www.eid.toshiba.co.nz

