

New User Interface

Highlight Feature

- > Personalised touch screen with changeable button size and design.
- > Routine tasks can be set on the home screen.
- > Smartphone-like user interface (UI) operability.
- > Preview screen can be operated through pinch in and out.
- > Efficient simple UI for grouping basic features.



Your challenge

Document processing and storage remains a major concern for various stakeholders in today's fast-moving and dynamic environment. Even with the investment of high-cost information infrastructure, there is still room for improvement in both front and back offices. Improvements in daily workflow efficiency can lead to a significantly better bottom line.

Our solution

Toshiba's new easy-to-use interface makes printing, scanning, copying and faxing easier. It allows you to create personalised functions according to your business needs. What's more, you can carry out your tasks quicker and more efficiently directly at the control panel of your Toshiba e-BRIDGE Next MFP.

NEW USER INTERFACE

Your benefits

The new control panel user interface (UI) allows you to select a desired application and smoothly navigate to the function of your choice.

You can create your own control panel experience by customising the screen background, design and size of the icons. You can also adjust the home screen settings according to your preferred usage patterns and workflows.

Use the "Simple UI" to collect and group basic settings and the "Advanced UI" to enable advanced settings depending on the task to improve both operational quality and efficiency.

The new UI also saves time, provides better system connectivity and improves response speed. This helps make the MFP an easy and integral part of your work day.

Where to use

Any company that captures, processes and stores information will realise the new UI can improve operational efficiency.

- > General Office
 - Increased productivity through quick task completion
- > Logistics
 - Fast information retrieval
- > Manufacturing
 - Customised layout and icons for different business units
- > Education/Retail
 - Intuitive "Simple UI"

The new Toshiba UI helps you retain the competitive edge in business by improving efficiency and effectiveness.

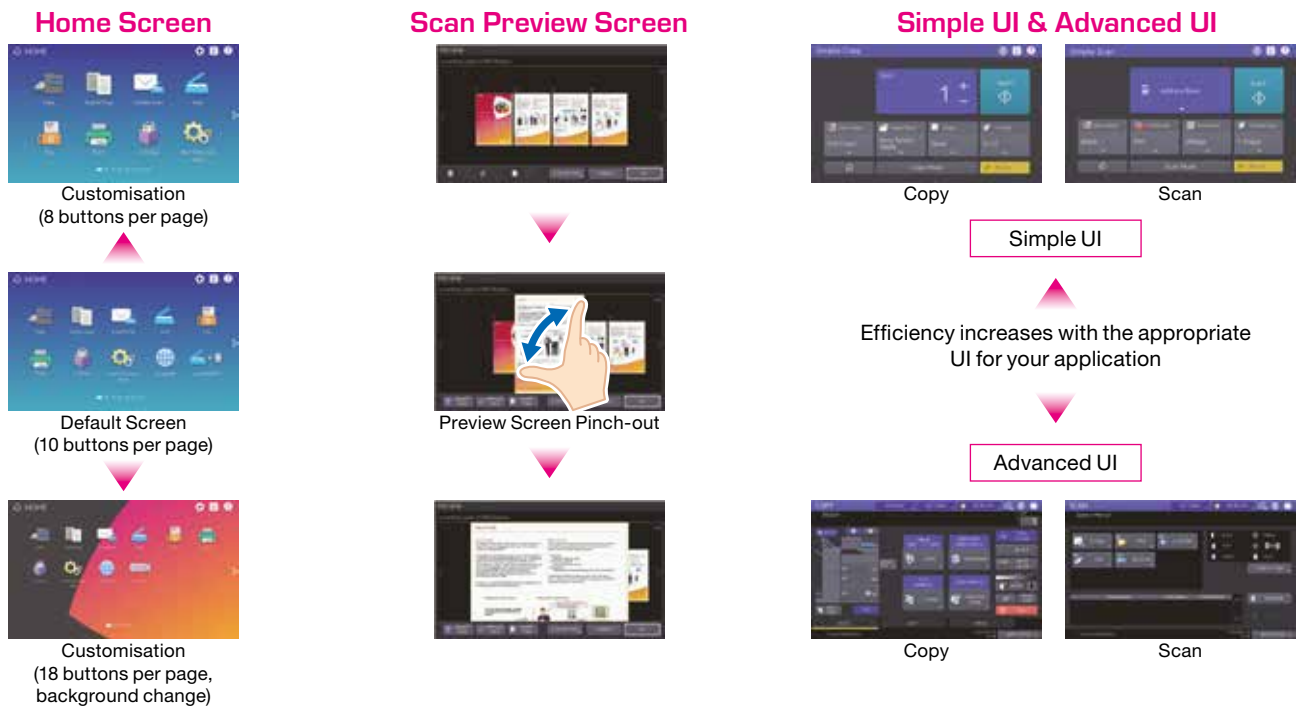

For more information and a complete list of MFPs with this feature please contact us:

TOSHIBA (Australia) Pty Limited
Building C, 12-24 Talavera Road,
North Ryde. 2113. Australia
Tel: 1300 794 202

New Zealand
58 Lunn Avenue, Mt Wellington
Tel: 09 570 8530

www.toshiba-business.com.au
www.toshiba-business.co.nz